

APPENDICES

APPENDICES

(CONTINUED)

Appendix D Space Definitions

Definitions per Postsecondary Education Facilities Inventory and Classification Manual (FICM): 2006 Edition were used as the foundation for space measurement.



Net Assignable Square Feet (NASF): The sum of all areas on all floors of a building assigned to, or available for assignment to, an occupant or specific use. This is also known as Net Square Feet (NSF) or Assignable Square Feet (ASF).

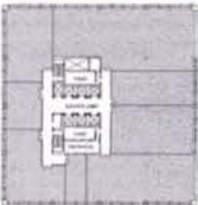

Net Usable Square Feet (NUSF): The sum of all areas on all floors of a building either assigned to, or available for assignment to, an occupant or specific use, or necessary for the general operation of a building. Also referred to as Usable Square Feet (USF).



Gross Square Feet (GSF): The sum of all areas on all floors of a building included within the outside faces of its exterior walls, including all vertical penetration areas, for circulation and shaft areas that connect one floor to another.